

# Beam

## Mounting a Ridge Beam Installation Instructions

### General Tools and Materials:

 Wood Beam(s)	 Lumber	 Wood Blocking 2"x4" or 2"x6" (for mounting)	 Wood Cutting Saw with Finish Blade	 Color Coordinating Textured Caulk	 1 1/4" Deck Screws	 Utility Knife	 Ladder	 Loctite® PL® Premium® 3X Construction Adhesive
 Caulk Gun	 Chalk Line/ Laser	 Screw Gun / Drill Driver & Bits	 Toggle / Lag Bolts	 Stud Finder	 Safety Glasses	 Tape Measure	 Square/ T-Bevel	
 Tack Cloth	 Painters Tape	 Pencil	 Clean Cloth	<b>24 Hours Before Starting</b> Acclimate all beams by storing them flat in the installation location (but away from moisture and direct sunlight or other heat sources) for at least 24 hours.				

### Installation Overview

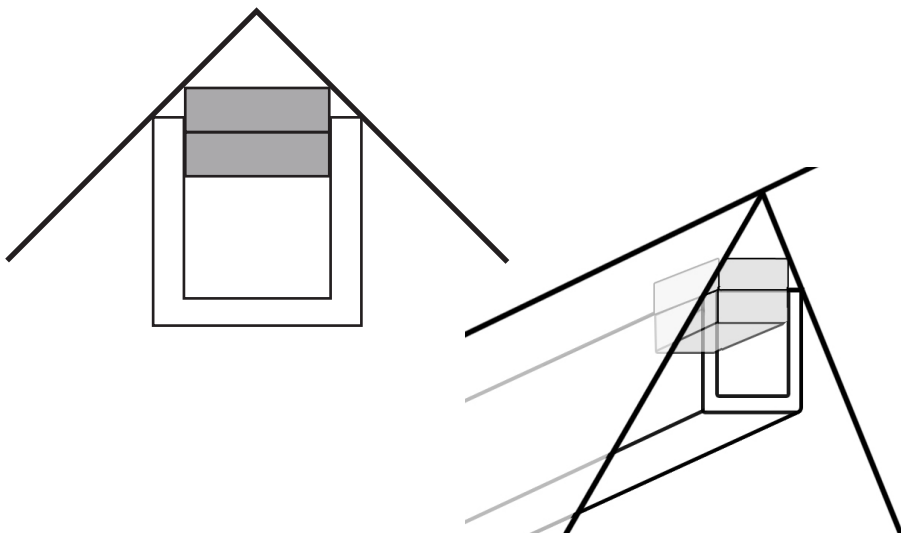

### WARNINGS:

- Be sure to obey all safety rules and recommendations set forth by tool manufacturers.
- Always comply with clearances set forth by the manufacturer of stoves, fireplaces, furnaces, and any other heat source.
- Wear safety glasses during the entire installation process.
- Beams are for decorative purposes only. They are not to be used for structural support, bracing or suspension of objects.
- Our products may have screws embedded below the surface. We recommend using a hand saw (not power tools) when cutting these products. You may locate screws with a stud finder. We are not responsible for any bodily harm or damage to your equipment if power tools are used.

# Mounting a Ridge Beam Installation Instructions

## Before You Start

1. Ensure surface is structurally sound and in good condition. Surfaces such as drywall should be flat and smooth to minimize gaps.
2. Gather all tools and materials.

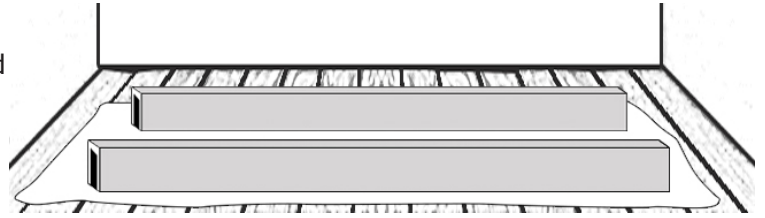

## 1 Determine Number of Mounting Blocks

Mounting blocks will be installed as stacked pairs. Determine the number of blocks:

1. A pair of blocks at each end of the beam **A**
2. At least every three feet along the beam. **B**
3. If using more than (1) decorative beam in a run, a pair of mounting blocks must be used at the joint where the decorative beams meet. **C**

$$\underline{A} \quad \underline{4} \quad + \underline{B} \quad + \underline{C} \quad = \quad \square$$

 Tape Measure

## 2 Cut Blocks and Drill Pilot Holes

1. Measure the inside dimension of the beam and subtract  $\frac{1}{8}$  inch to determine the size of the mounting blocks.
2. Cut the appropriate number of mounting blocks determined in *Step 1*. Dry fit each of the blocks to ensure that they don't have to be forced onto the beam. Too tight a fit could damage the beam.
3. Drill pilot holes in the mounting blocks. Be sure to offset the holes so that the blocks can be stacked.

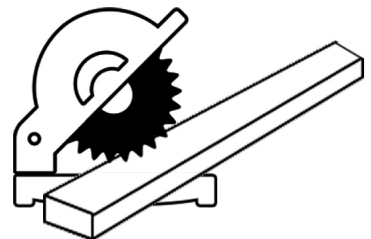
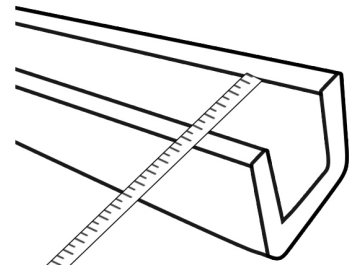

Screw Gun /  
Drill Driver  
& Bits



Measuring  
Tape



Wood Saw



Lumber



Square/  
T-Bevel

# Mounting a Ridge Beam Installation Instructions

## 3 Attach Mounting Blocks to Ceiling

1. Attach the first mounting block, centered on the ceiling apex and as close to the side wall as possible.
2. Attach the second block directly below the first.
3. Mark the location of the mounting blocks by placing painters tape on the ceiling about 1 ½ inches from the lower block.
4. Secure additional mounting blocks approximately every 3 feet and at the end of the run as close to the side wall as possible. If joining more than (1) beam, ensure that there are at least 2 sets of mounting blocks at the point where the beams will meet and that the blocks project 2 to 3 inches on both sides of the joint.

**NOTE:** Screws need to be long enough to go through the wood block, the sheetrock or plaster, and into the studs.

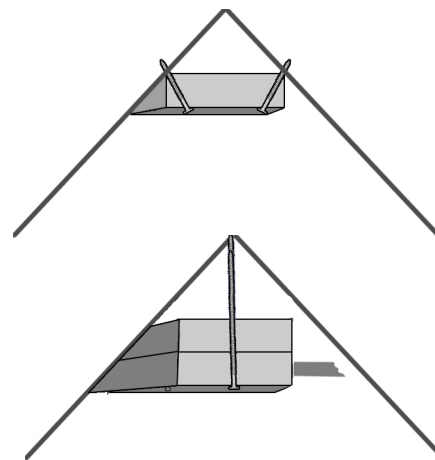

## 4 Dry Fit

1. Check beam length by dry fitting in place.
2. Trim/miter beam if needed. It is best to cut the beam slightly long (about 1/8") to ensure a tight fit.

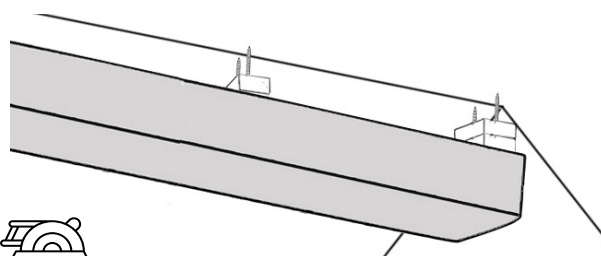

**WARNING:** Our products may have screws embedded below the surface. We recommend using a hand saw (not power tools) when cutting these products. You may find these screws with a stud finder. We are not responsible for any bodily harm or damage to your equipment if power tools are used.

## 5 Apply Adhesive

1. Wipe the edges of the mounting blocks and the inside of the beam with a tack cloth to remove debris.
2. Apply adhesive to the edges of the mounting blocks that contact the beam.



Tack Cloth



Adhesive



Caulk Gun

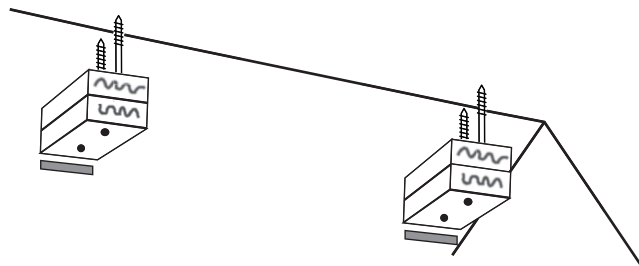

# Mounting a Ridge Beam Installation Instructions

## 6 Install Beam

1. Slide beam in place over the mounting blocks.
2. Using the painters tape as a guide, slightly countersink (4) screws, (2) per side, through the beam and into the mounting block to hold the beam until the adhesive dries.
3. Immediately wipe off any visible adhesive using a clean cloth.



Clean Cloth



Screws



Screw Gun /  
Drill Driver  
& Bits

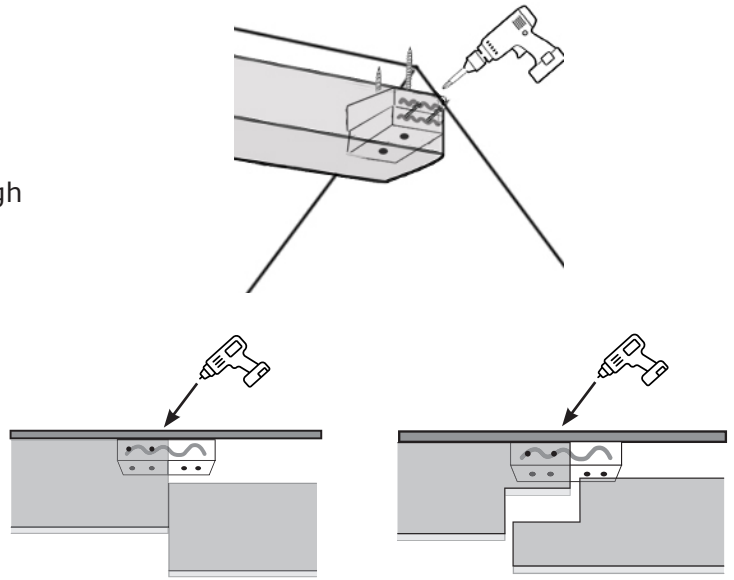

## 7 Touch-Up

1. Apply color complimenting textured caulk to fill screw holes. Blend caulk into adjacent surfaces while it is still wet.
2. Where necessary, apply caulk to joints and gaps.
3. Use paint from the touch-up kit to paint over the caulk.

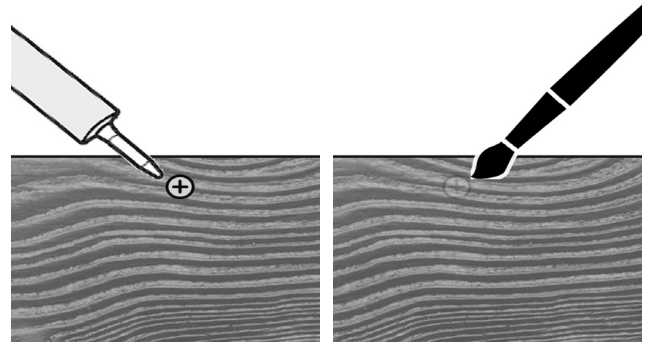

Caulk



Caulk Gun



Touch-Up Kit



Small  
Paint Brush



Painters  
Tape



Clean Cloth



Utility Knife

**HINT:** Apply painters tape where the beam and wall meet to ensure a straight caulk line. Remove the tape once the caulk has dried completely.